



Cortadores multicable **CON MATRACA**

Fuerza manual reducida que permite realizar cortes con más facilidad



**KLEIN
TOOLS**



Para Profesionales... Desde 1857

Cortadores multicable CON MATRACA

- Fuerza manual reducida que permite realizar cortes con más facilidad
- El mecanismo de matraca de dos pasos patentado requiere de menos golpes por corte
- La palanca de liberación rápida abre las cuchillas fácilmente en cada posición de corte, lo que permite la extracción del cable antes de completar el corte
- Cuchillas de corte de acero templado que ofrecen resistencia y filo duraderos
- La palanca de bloqueo mantiene los mangos cerrados para facilitar el traslado; la herramienta cabe en una caja o una maleta portaherramientas



Cortador multicable con matraca 63060

- Cobre **600 MCM**
- Aluminio **750 MCM**
- La mayor capacidad de corte y la fuerza manual reducida facilitan el corte de cables de gran diámetro



Cortador multicable ACSR con matraca 63607

- ACSR **336 MCM**
- Cobre **400 MCM**
- Aluminio **600 MCM**
- Las cuchillas templadas de modo selectivo y la fuerza manual reducida facilitan el corte de cables ACSR

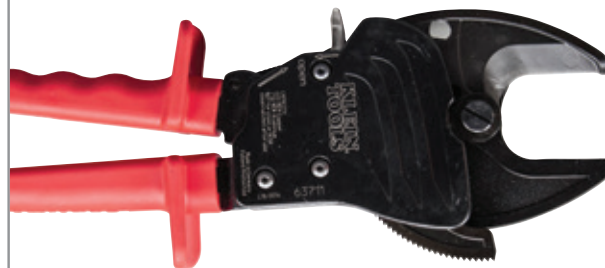

Cortador multicable de mordaza abierta con matraca 63711

- Cobre **600 MCM**
- Aluminio **750 MCM**
- Mordazas de carga frontal para aplicaciones en espacios estrechos



Cortador multicable con matraca 63750

- Cobre **1000 MCM**
- Aluminio **1000 MCM**
- Para cables de gran diámetro

Cat. n.º	UPC 0-92644+	Cobre (MCM)	Aluminio (MCM)	Cable de comunicaciones	ACSR (MCM)	Longitud total	Peso en libras (kg)
63060	63060-6	600 (300 mm ²)	750 (400 mm ²)	1-1/8" (28 mm)	N/D	10-1/4" (260 mm)	1,3 (0,59 kg)
63607	63607-3	400 (185 mm ²)	600 (300 mm ²)	N/D	336 MCM (170 mm ²)	10-1/4" (260 mm)	1,5 (0,68 kg)
63711	63711-7	600 (300 mm ²)	750 (400 mm ²)	1-1/8" (28 mm)	N/D	11-1/2" (292 mm)	2,0 (0,91 kg)
63750	63750-6	1000 (500 mm ²)	1000 (500 mm ²)	2-1/16" (52 mm)	N/D	12-1/8" (308 mm)	1,8 (0,82 kg)



Vea nuestra línea completa de cortadores multicable

www.kleintools.com.mx



KLEIN TOOLS EST. 1857

Para Profesionales... Desde 1857

160 AÑOS 1857-2017

© 2017 Klein Tools, Inc.
Lincolnshire, IL 60069
96496-ES Rev. 05/17 A

**REPLACEMENT PART KITS FOR RATCHETING
CABLE CUTTER 63060 ONE-STEP MECHANISM**

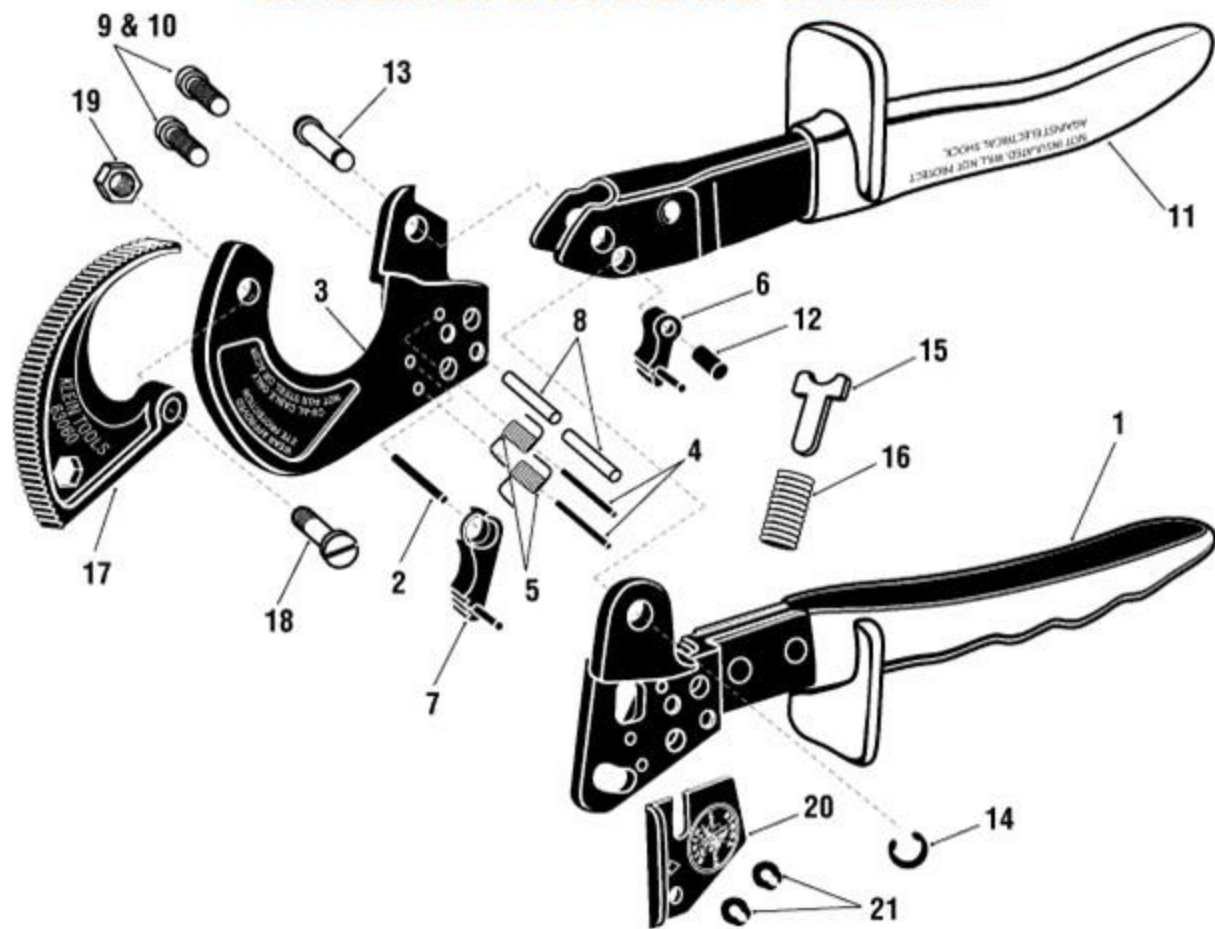

Catalog No.	Replacement Part Kits	Parts Breakout Illus. No.
63065	Body Spring & Guide Set	
	Main body spring guide	15
	Main body spring	16
63364	Moving Blade Set	
	Moveable cutting blade	17
	Fulcrum cutter screw	18
	lock nut for fulcrum cutter screw	19
63365	Fixed Blade Set	
	Fixed cutting blade	3
	Two grooved fasteners	8
	Two hex socket screws	9
	Moveable handle pivot pin	13
	Snap ring	14
63366	Ratchet Pawl Set	
	Grooved fastener for stopper pawl	2
	2 Springs	5
	Small ratchet pawl	6
	Large ratchet pawl	7
	Pivot cylinder for main ratchet pawl	12
63367	Moving Handle Set	
	Moveable top handle assembly	11
	Pivot cylinder for main ratchet pawl	12
	Moveable handle pivot pin	13
	Snap ring	14
63368	Fixed Handle Set	
	Fixed bottom handle assembly	1
	Grooved fastener for stopper pawl	2
	Moveable handle pivot pin	13
	Snap ring	14
63369	Ratchet Release Plate Set	
	Two hex socket screws for fixed blade	9
	Ratchet release plate	20
	Slotted nut	21

SAFETY OPERATING & MAINTENANCE INSTRUCTIONS

Ratcheting Cable Cutter

RCC-325



Certificate No. TW-HSPM-1237

ISO 9001:2000

ISO 14001:2004

WARRANTY

The KuDos® RCC-325, excluding the cutting blades, is warranted to be free of defects in materials and workmanship for a period of 90 days , except in the case of abuse or modification.

FEATURES AND BENEFITS

- Cuts up to 400MCM (200 sq.mm) hard drawn copper.
- Cuts up to 600MCM (325 sq.mm) soft copper, aluminum and multiple conductor cable.
- Simple, one-hand operation.
- Single speed ratchet mechanism.
- Quick release mechanism for removal of cable to completion of cut.
- Tool can be locked in closed position.
- Convenient for working in tight places and easy to store.

OPERATION

- 1) While using, unlock the steering wheel locking plate. Be sure that the locking plate is back in its home position for safely after use.
(See Figure 1)
- 2) Pull down on blade ratchet release plate (OPEN) to release blade from ratcheting mechanism.
- 3) Place cable to be cut against stationary blade and rotate movable blade until it is also against cable.
- 4) Squeeze handles continuously until cable is cut.
- 5) If cable need to be released before the cut is completed, pull blade ratchet plate (OPEN) and cable can easily be removed.

PREVENTIVE MAINTENANCE

The service life of a tool can be greatly improved with proper care and maintenance. To extend the life of your RCC-325 Ratcheting Cable Cutter, keep it clean and well lubricated every three months. .

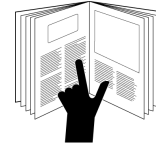

WARNING

Read and understand all of the instructions and safety information in this manual before operating or servicing of this tool. Other use of this tool may lead to serious personal injury or death.



DANGER

Tool are **NOT** insulated for use on near energized conductors. Use of these tools near energized conductors may lead to electrical shock, causing severe injury or death.

DO NOT use these tools near energized conductors without adequately insulating operator and surroundings

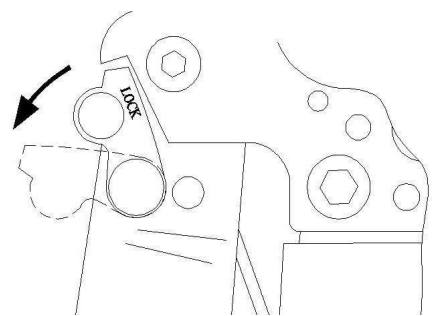

Figure 1

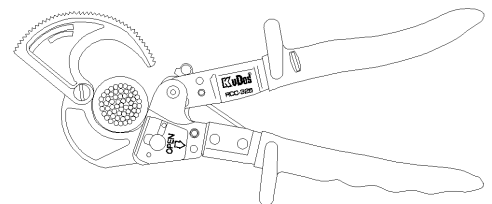

Figure 2



**NOT FOR USE ON ACSR CABLE
XLPE OR STEEL WIRE**

KuDos[®]

Your Forever Working Partner.

REF. 99242 (Fabrica SCC60)

Cizalla manual cable Cu 1/0AWG - varilla acero 3mm

Cable Tipo: Cobre hasta 60mm².

Alambre acero: 3mm Max.

Origen: Taiwan

FOR STEEL ROD: 5MM MAX. WIRE ROPE: 7MM MAX. COPPER CABLE: 60 SQ.MM.

LENGTH: 310MM

WEIGHT: 0.73KGS

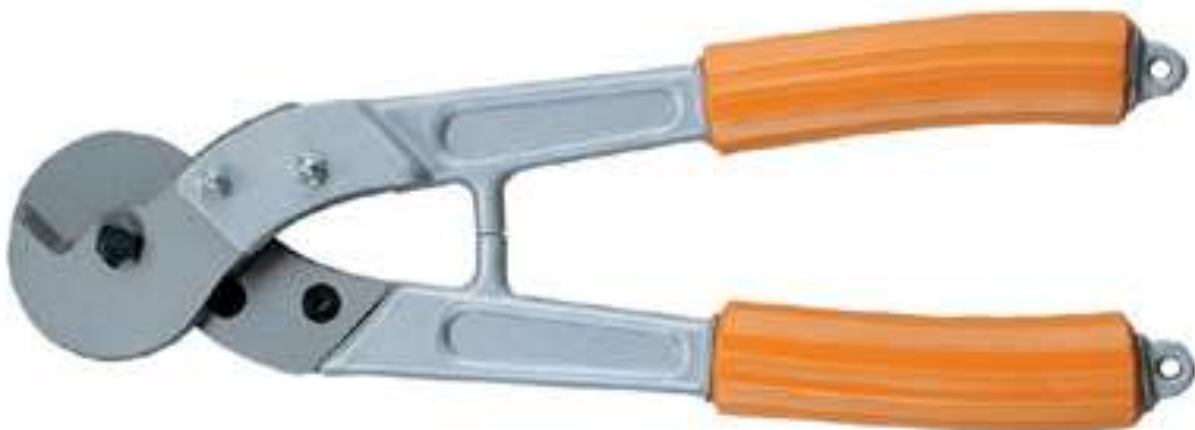

HIGH TENSILE STEEL BOLT CUTTERS WITH INSULATED FIBERGLASS HANDLES

- Suitable for cutting hard material
- Short cutting edge for high tensile steel, bolts, wire, rods, chain links, and case hardened chains
- Handles are filled with unicellular foam core
- Same fiberglass used in all HASTINGS Hot Sticks



10-765

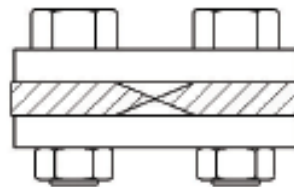

CENTER CUT

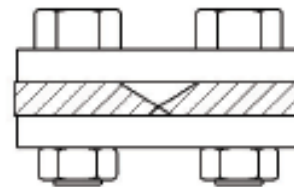

CLIPPER CUT

BOLT CUTTERS				MAXIMUM CUTTING CAPACITY DIAMETER				HEAD ONLY
STYLE OF HEAD	CAT NO	HANDLE	OVERALL CUTTER LENGTH	HRC - BRINELL 140 49.6kg/mm 32 tons/sq. in. REINFORCEMENT STEEL	HRC 20 BRINELL 230 77.5kg/mm 50 tons/sq. in. BAR STEEL	HRC 40 BRINELL 370 133kg/mm 85 tons/sq. in. STEEL WIRE	HRC 48 BRINELL 450 162kg/mm 105 tons/sq. in. MUSIC WIRE	
CLIPPER CUT	10-365	12"	18"	7mm / 1/4"	6mm / 1/4"	5mm / 3/16"	5mm / 3/16"	A11010
	10-367	8"	14"			6mm / 1/4"	5.5mm / 7/32"	A11010
	10-465	18"	25"	8mm / 5/16"		6mm / 1/4"		A11011
	10-467	11"	18"					A11011
CENTER CUT	10-665	24"	32"	10mm / 3/8"	8mm / 5/16"	8mm / 5/16"	7mm / 9/32"	A11012
	10-666	12"	20"					A11012
	10-667	16"	24"					A11012
	10-669	14"	22"					A11012
	10-765	24"	33"	13mm / 1/2"	10mm / 3/8"	9mm / 11/32"	8mm / 5/16"	A11013
	10-767	21"	30"					A11013
10-965	26"	36"	16mm / 5/8"	12mm / 15/32"	10mm / 3/8"	9mm / 11/32"	A11014	



Cortador con matraca de alta resistencia



Especificaciones

:	Cortador multicable	Longitud total:	28" (71,1 cm)
Peso:	14,0 lb (6,4 kg)		

CC-400LT



Detail

For copper and aluminum cable up to 400 sq.mm. AWG 800 MCM.

Compound handles design, easy cutting.

Aluminum tube handles

Length: 700 mm

Weight: 1.57 kgs

EBCHQ

99264

Model No:

RCC-325

Manual cable cutter



Cutter

Manual Cable Cutter

SPECIFICATION:

- Cutting capacity:
 - Cuts up to 400mcm (200sq.mm) hard drawn copper
 - Cuts up to 600mcm (325sq.mm) soft copper, Al. And multiple conductor cable

SIZE

250mm

WEIGHT

0.65kg

ACCESSORIES

FEATURES:

- Cutting blade wide enough to keep the shape
- Single speed ratchet mechanism
- Quick release mechanism for removal of cable to completion of cut
- Tool can be locked in closed position
- Convenient for working in tight places and easy to store

KuDos[®]

Your Forever Working Partner.

REF. 99262 (Fabrica RCC-500PH)

Tipo: Rache

Material: Cobre

Rango: Cable Hasta 2700 pares.

Origen: Taiwan

TELCO CUTTER CUTS UP TO 2700 PAIRS CABLE.

LENGTH: 340MM

WEIGHT: 1.20KGS

